

# RC4 Quick Start Guide

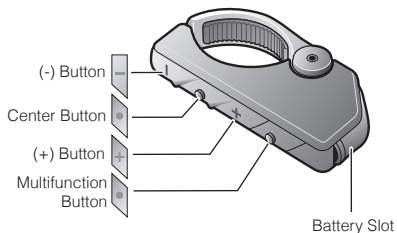

## Getting Started

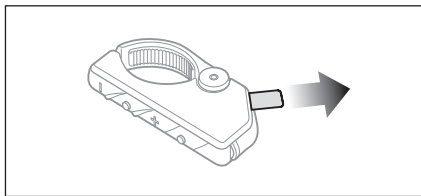

Remove the plastic tape from the battery slot to begin using the RC4.

## Installation

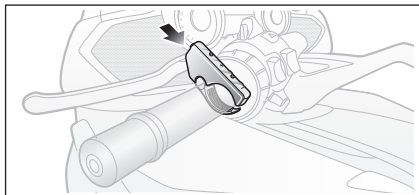

### Note:

If your handlebar requires better grip for holding the RC4 in place, apply the rubber band around the handlebar.

## Replacing the Battery

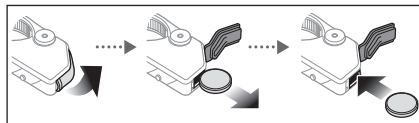

## Button Operation

- ← Tap Tapping
- ←← Tap Double Tapping
- ← 1" Press for 1 sec

## Power On/Off

### Power On

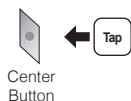

### Deep Sleep

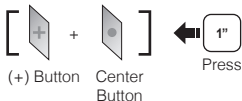

## Battery Check

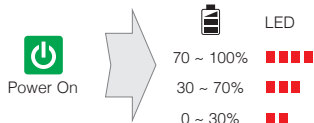

## Bluetooth Pairing

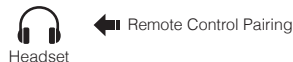

### Note:

- You can control the headset using the RC4 only after you pair them together.
- The RC4 supports Sena headsets with Bluetooth 4.1 or higher.

## Factory Reset

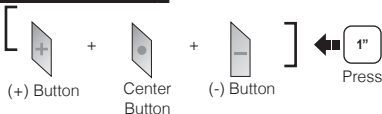

## Headset Control

To control your headset using the RC4, please refer to the Quick Reference Guide for button operations on functions such as phone, music, and intercom.

### Note:

The Multifunction Button remotely controls special buttons such as the Mesh Intercom Button, the Camera Button and the Ambient Mode Button. Please refer to the Quick Reference Guide for more details.



**Sena Technologies, Inc.**  
Customer Support: [sena.com](http://sena.com)